



BEER BASICS & TASTING

BEER

KNOWLEDGE & TASTING



WATER



HOPS



GRAIN



YEAST

*4 Key ingredients to
make Beer*

MALT

Barley is the preferred grain for beer. But the starch in a grain of barley isn't ready to be fermented into alcohol, so the barley is generally converted into malted barley, or "malt." The process of malting involves soaking the barley, allowing it to germinate, and then stopping germination with heat.

HOPS

Hops are the spice of beer. They provide bitterness to balance the sweetness of the malt, as well as flavors and aromas ranging from citrus and pine to earthy and spicy.

YEAST

Yeast is the microorganism that is responsible for fermentation in beer. Yeast metabolizes the sugars extracted from grains, which produces alcohol and carbon dioxide, and thereby turns wort into beer. In addition to fermenting the beer, yeast influences the character and flavor.

ABV - ALCOHOL BY VOLUME

Alcohol by volume, or ABV, is used to measure the alcohol content of beer. Beers typically fall in the 3.0 to 13.0 percent ABV range, with the majority being 4.0 to 7.0 percent ABV.

IBU - INTERNATIONAL BITTERNESS UNIT

The standard used by brewers to indicate the bitterness level of a beer. A Pils which has 30 to 40 IBU units, will have the same level of bitterness as an English Ale that is indicated with the same numbers.

BEER

POURING THE PERFECT DRAFT

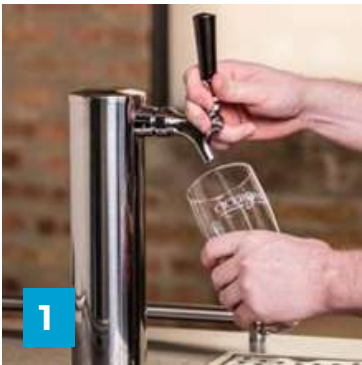

1. ANGLE

Hold the clean beer glass (or cup) at a 45 angle. Do not let the faucet touch the glass

2. TAP

Fully open the faucet by the base in one fluid motion. Do not let the faucet touch the beer

3. FINISH

Gradually straighten the glass as you pour. Aim for the center of the glass

4. HEAD

This technique will result in a perfect 1" foam pour

BEER READY GLASSWARE



“Flat” Beer
Film or grease attack the foam,
reducing the appeal

“False” Beer
Rapid loss of foam requiring refills to
“top off”

“Off” Taste Beer
Odors from sanitizers, bar towels and improper
storage affects quality

WATER TEST - Submerge the glass in water, when you lift it out the water should sheet off of the glass. If droplets cling that is a sign of film present.

SALT TEST - Sprinkle salt into a wet glass, it should adhere evenly to the glass vs. sinking to the bottom or sticking randomly. Salt will stick wherever a greasy film is present.

BUBBLE TEST - Beer in the glass should be clear with no bubbles rising from the bottom of the glass or clinging to the side. Bubbles indicate a dirty glass. (Exception: Sam Adams specialty glasses have an etched bottom to create release of bubbles from the bottom of the glass)

FOAM TEST - The foam or head should stay present as the guest drinks the beer. After each sip, a ring of foam should adhere to the glass. This is called lacing, and when a guest is finished you should be able to count the number of sips taken to finish the beer.

KEG TAPPING

1. Do not agitate the keg. If there has been excessive agitation during transport, allow the keg to settle for 1 to 2 hours before tapping
2. Make sure the beer faucet is in the off position prior to tapping
3. Make sure that the keg coupler handle is in the up (off) position
4. Align lug locks on tavern head with lug housing in top of keg; insert tavern head
5. Turn tavern head handle 1/4 turn clockwise; the tavern head is now secured to keg
6. Rotate on/off valve hand 1/4 turn clockwise to open beer and CO2 ports in keg. The keg is now tapped

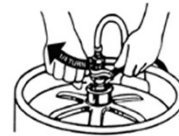

Tapping the keg properly will activate both the beer and the CO2 pressure line. The keg will be ready to draw beer.

If kegs are attached to FOB regulators, open the airline by untwisting the screw top and letting out the air till the bobber rises to the top. Twist the screw top closed.

BEER TROUBLESHOOTING

WILD / FOAMY BEER

- Warm draft cooler/ frozen glasses
- Beer line system not properly refrigerated or insulated Beer drawn improperly
- Tap/faucets broken, leaking or dirty
- Too much pressure



FLAT BEER

- Beer too cold
- Not enough CO2 / Beer Gas pressure
- Sluggish (broken) pressure regulator
- Air compressor used for pressure
- Pressure required does not correspond to beer temp



CLOUDY BEER

- Beer over chilled or frozen in dispensing system
- Beer has been frozen in barrel
- Old beer hose in poor condition





THE LODGE:
DRAFT BEER

BEER

TASTING NOTES



BRAND/NAME

Bud Light

STYLE

American Light Lager

COUNTRY OF ORIGIN

United States – St. Louis, MO

ABV

4.2%

IBU

6

COLOR

Pale yellow

AROMA

Subtle hops with delicate malt sweetness

TASTE

Light-bodied with a fresh, clean hop flavor, mild sweetness, and crisp finish

PACKAGE

DRAFT

BEER

TASTING NOTES



BRAND/NAME

Corona Extra

STYLE

Mexican Lager

COUNTRY OF ORIGIN

Mexico

ABV

4.6%

IBU

19

COLOR

Golden

AROMA

Fruit, honey aromas and a touch of malt

TASTE

Crisp, clean and well-balanced between hops and malt

PACKAGE

DRAFT

BEER

TASTING NOTES

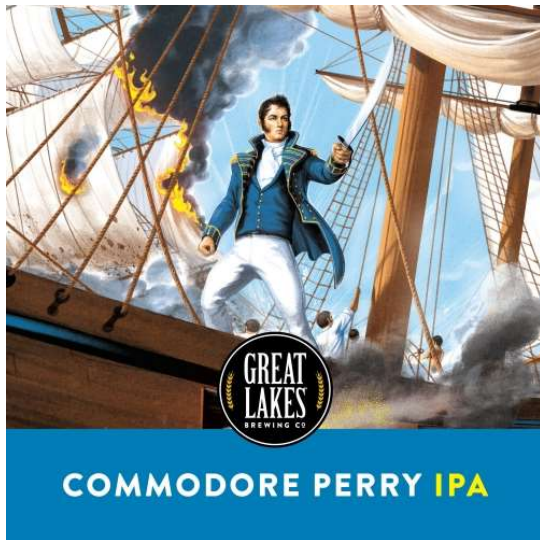

BRAND/NAME

Great Lakes Commodore Perry

STYLE

India Pale Ale

COUNTRY OF ORIGIN

United States – Cleveland, OH

ABV

7.7%

IBU

70

COLOR

Clear Copper

AROMA

Herbal & Citrusy

TASTE

Spicy and resinous, bitter hop flavors balanced with caramel malt. Medium bodied with a dry, fruity finish.

PACKAGE

DRAFT

BEER

TASTING NOTES



BRAND/NAME

Guinness

STYLE

Irish Dry Stout

COUNTRY OF ORIGIN

Ireland (US – Baltimore, MD)

ABV

4.2%

IBU

45

COLOR

Dark amber, nearly black

AROMA

Roasted chocolate malt, slight coffee sweetness

TASTE

Malt with chocolate and coffee flavors, finishing creamy and dry

PACKAGE

DRAFT

BEER

TASTING NOTES



BRAND/NAME

Michelob Ultra

STYLE

Light American Lager

COUNTRY OF ORIGIN

United States – St. Louis, MO

ABV

4.2%

IBU

10

COLOR

Light gold

AROMA

Mild biscuit and subtle light citrus

TASTE

Crisp and refreshing mild, malt taste with hints of citrus and a dry finish

PACKAGE

DRAFT

BEER

TASTING NOTES

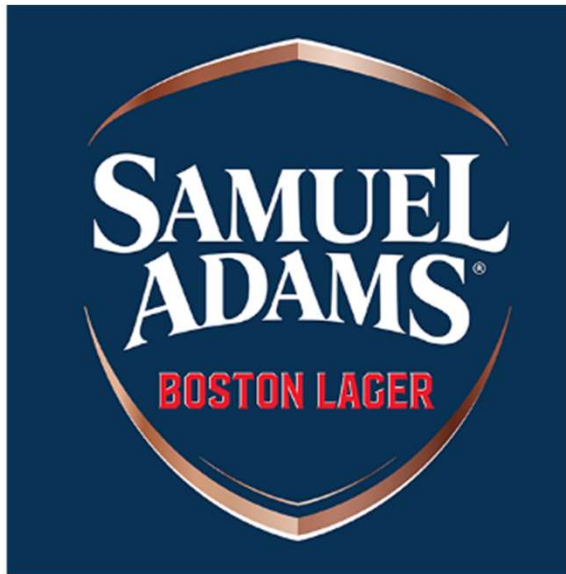

BRAND/NAME

Samuel Adams Boston Lager

STYLE

Vienna-Style American Lager

COUNTRY OF ORIGIN

United States – Boston, MA

ABV

5.0%

IBU

30

COLOR

Deep amber to golden

AROMA

Spicy hops, with a sweet biscuity malt

TASTE

A distinctive balance of spicy hops, slightly sweet roasted malts, and a smooth finish

PACKAGE

DRAFT

BEER

TASTING NOTES



BRAND/NAME

Sierra Nevada Hazy Little Thing NEIPA

STYLE

Hazy New England IPA

COUNTRY OF ORIGIN

United States – Boston, MA

ABV

6.7%

IBU

35

COLOR

Hazy bright yellow

AROMA

Sweet citrus and pine

TASTE

Hoppy but not bitter, pine, pineapple and citron with a finish of faint spice and wheat

PACKAGE

DRAFT

BEER

TASTING NOTES



BRAND/NAME

Stella Artois

STYLE

European Pilsner

COUNTRY OF ORIGIN

Belgium (US – St. Louis, MO)

ABV

5.0%

IBU

24

COLOR

Golden

AROMA

Floral hops with toasted malt

TASTE

Slightly sweet with a clean, crisp hop finish

PACKAGE

DRAFT

BEER

TASTING NOTES

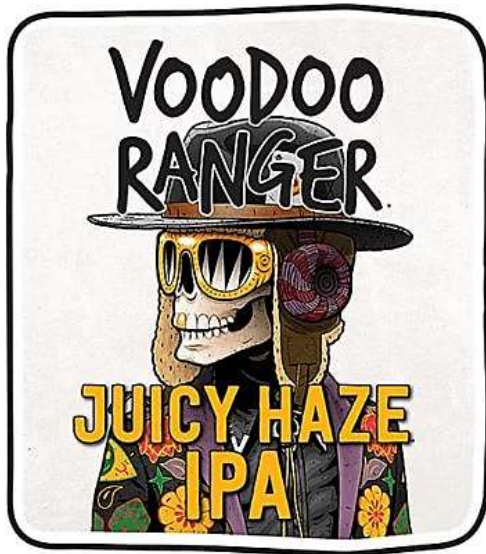

BRAND/NAME

Voodoo Ranger Juicy Haze IPA

STYLE

New England IPA

COUNTRY OF ORIGIN

United States – Fort Collins, CO

ABV

7.7%

IBU

50

COLOR

Golden

AROMA

Strong hop, citrus lemon, orange, lime and grapefruit

TASTE

Strong citrus flavors with orange and grapefruit, some piney elements with low tropical notes.

PACKAGE

DRAFT



THE LODGE:
PACKAGED BEER & SELTZER

BEER

TASTING NOTES



BRAND/NAME

Blue Moon Belgian White

STYLE

Wheat Ale

COUNTRY OF ORIGIN

United States – Denver, CO

ABV

5.0%

IBU

9

COLOR

Hazy orange-gold

AROMA

Fresh coriander and bright citrus orange peel

TASTE

Nice and complex with citrus notes, finishing fairly dry.

PACKAGE

DRAFT

BEER

TASTING NOTES



BRAND/NAME

Bud Light

STYLE

American Light Lager

COUNTRY OF ORIGIN

United States – St. Louis, MO

ABV

4.2%

IBU

6

COLOR

Pale yellow

AROMA

Subtle hops with delicate malt sweetness

TASTE

Light-bodied with a fresh, clean hop flavor, mild sweetness, and crisp finish

PACKAGE

DRAFT

BEER

TASTING NOTES



BRAND/NAME

Coors Light

STYLE

American Light Lager

COUNTRY OF ORIGIN

United States – Golden, CO

ABV

4.2%

IBU

10

COLOR

Pale yellow

AROMA

Floral hops with malt sweetness

TASTE

Mild malt sweetness with a crisp finish

PACKAGE

DRAFT

BEER

TASTING NOTES

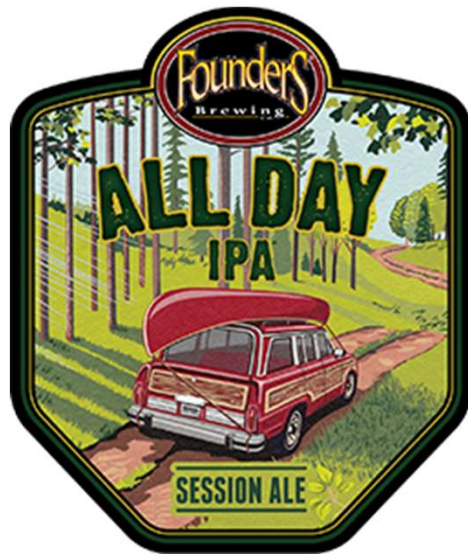

BRAND/NAME

Founder's All Day IPA

STYLE

India Pale Ale

COUNTRY OF ORIGIN

United States – Grand Rapids, MI

ABV

4.7%

IBU

42

COLOR

Golden Yellow

AROMA

Juicy tangerine, light grass, and pine with subtle malt

TASTE

Refreshing citrus, floral, and tropical fruit notes, with moderate bitterness and a crisp clean finish

PACKAGE

DRAFT

BEER

TASTING NOTES



BRAND/NAME

Great Lakes Dortmund Gold

STYLE

Dortmunder Lager

COUNTRY OF ORIGIN

United States – Cleveland, OH

ABV

5.8%

IBU

30

COLOR

Deep Gold

AROMA

Malt, hay and earthy hops

TASTE

Balanced sweet malt with smooth, crisp and refreshing dry hop flavors

PACKAGE

DRAFT

BEER

TASTING NOTES

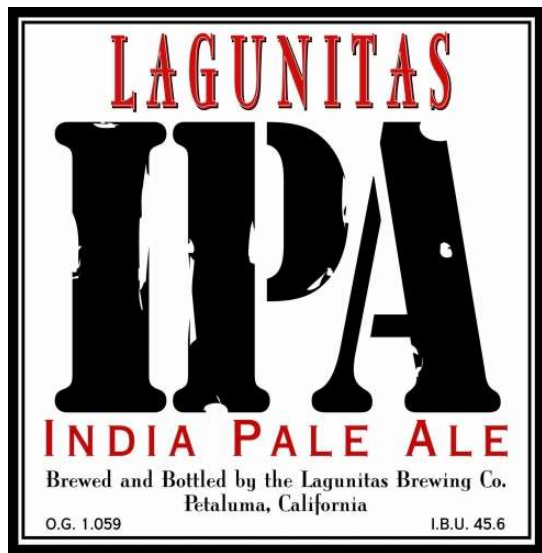

BRAND/NAME

Lagunitas IPA

STYLE

IPA - American

COUNTRY OF ORIGIN

United States – Petaluma, California

ABV

6.2%

IBU

51

COLOR

Clear, Amber Golden

AROMA

Notes of biscuit, malt with slight pine and sweetness

TASTE

Caramel malt barely provides the richness that mellows out the twang of the hop

PACKAGE

DRAFT

BEER

TASTING NOTES



BRAND/NAME

Michelob Ultra

STYLE

Light American Lager

COUNTRY OF ORIGIN

United States – St. Louis, MO

ABV

4.2%

IBU

10

COLOR

Light gold

AROMA

Mild biscuit and subtle light citrus

TASTE

Crisp and refreshing mild, malt taste with hints of citrus and a dry finish

PACKAGE

DRAFT

BEER

TASTING NOTES



BRAND/NAME

Miller Lite

STYLE

American Light Lager

COUNTRY OF ORIGIN

United States – Milwaukee, WI

ABV

4.2%

IBU

10

COLOR

Deep golden

AROMA

Medium malt and hop

TASTE

Hop-forward and solid malt character, smooth medium body with a crisp, clean finish

PACKAGE

DRAFT

BEER

TASTING NOTES



BRAND/NAME

Modelo Especial

STYLE

Pilsner-Style Mexican Lager

COUNTRY OF ORIGIN

Mexico

ABV

4.4%

IBU

12

COLOR

Rich, golden yellow

AROMA

Orange blossom and honey with a hint of herb

TASTE

Well-balanced, light hop character with a crisp, clean finish

PACKAGE

DRAFT

BEER

TASTING NOTES



BRAND/NAME

Yuengling

STYLE

Traditional Lager - American

COUNTRY OF ORIGIN

United States – Pottsville, Pennsylvania

ABV

4.5%

IBU

16

COLOR

Clear, Amber/Red

AROMA

Toasted malt, biscuit and slight caramel

TASTE

Roasted caramel malt for a subtle sweetness and a combination of cluster and cascade hops

PACKAGE

DRAFT

BEER

TASTING NOTES



BRAND/NAME

High Noon

STYLE

Varies

COUNTRY OF ORIGIN

United States

ABV

4.5%

IBU

NA

COLOR

Clear, bubbly

AROMA

Fruit forward

TASTE

Bursting with fresh-picked, sun-drenched, perfectly ripe flavors.

PACKAGE

DRAFT

SELTZER

TASTING NOTES



BRAND/NAME

White Claw Hard Seltzer

STYLE

Black Cherry Hard Seltzer

COUNTRY OF ORIGIN

United States – Chicago, IL

ABV

5.0%

IBU

NA

COLOR

Clear, bubbly

AROMA

Slight fruit and malt sweetness

TASTE

Balanced fresh fruit flavors with mild malt sweetness

PACKAGE

DRAFT